

## DIN 46267 Aluminum Butt-connectors

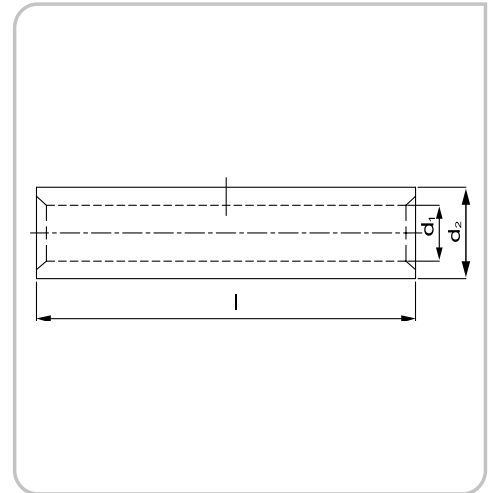

### Features

- Manufactured according to DIN 46267
- The butt-connectors are marked for correct crimping
- Please crimp with Aluminum dies
- These butt-connectors must be crimped with AL series dies

**Material** : E-Al  
**Surface Treatment** : Tin, bright

Product Code	Cross-Section mm <sup>2</sup>	Dimensions (mm)			Box Amount
		d1	d2	l	
AL EM016	<b>16 mm<sup>2</sup></b>	5,8	9,7	55	200
AL EM025	<b>25 mm<sup>2</sup></b>	6,8	11,4	70	150
AL EM035	<b>35 mm<sup>2</sup></b>	8,0	13,9	85	80
AL EM050	<b>50 mm<sup>2</sup></b>	9,8	16,4	85	50
AL EM070	<b>70 mm<sup>2</sup></b>	11,2	18,4	105	40
AL EM095	<b>95 mm<sup>2</sup></b>	13,2	21,2	105	30
AL EM120	<b>120 mm<sup>2</sup></b>	14,7	23,5	105	25
AL EM150	<b>150 mm<sup>2</sup></b>	16,3	25,5	125	15
AL EM185	<b>185 mm<sup>2</sup></b>	18,3	29	125	12
AL EM240	<b>240 mm<sup>2</sup></b>	21,0	32	145	8
AL EM300	<b>300 mm<sup>2</sup></b>	23,3	38,5	145	6
AL EM400	<b>400 mm<sup>2</sup></b>	26,0	42	188	4

\* Our company reserves the right of changing the dimension of the products without any prior notification.